

# Snap Gauges



Our Snap Gauges are designed for quick inspection of outside diameter of work pieces.

 1- 400mm

 Customisation available

 Carbide | Steel

 Metric & Imperial

 IS: 3455 (standard for manufacturing tolerance)

## Specifications

### Product Information

- We offer Snap gauges in Steel and Carbide. We also make gauges in Steel with measuring faces in Carbide.
- We also manufacture Snap Gauges to relevant I.S., B.S. and DIN standards based on customer requests from 1- 400mm diameter.
- Single ended and double ended types of snap gauges are available with proper marking of 'GO', NOGO & gauge identification.
- They are also designed as per customer specification for checking of length, thickness & groove diameters etc.

### Technical Specifications

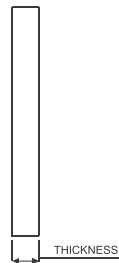
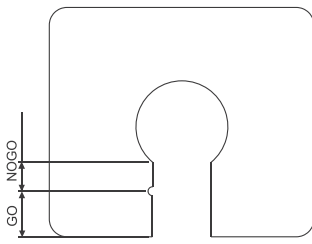

Type	Range	'GO' Length	'NO GO' Length	Thickness
Single Ended Snap Gauge Steel Blank (Carbide tipped/Steel)	1 – 10	12	7	6

\* All figures in mm

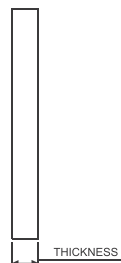
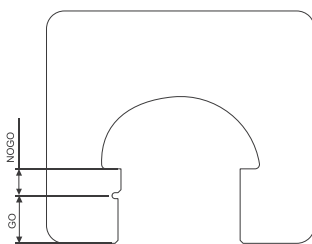

Type	Range	'GO' Length	'NO GO' Length	Thickness
Single Ended Snap Gauge Steel Blank (Carbide tipped /Steel)	10-16	12	7	6
	16-25	12	7	8.5
	25-32	12	7	8.5
	32-45	16	9	8.5

## Unique Features

### Features of Snap Gauges

- High Durability
- High Tensile Strength



Certificate No. : C-0432

KCP Snap Gauges are supplied with Calibration Certificate issued from its accredited calibration lab.

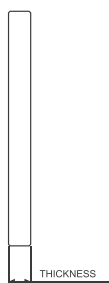
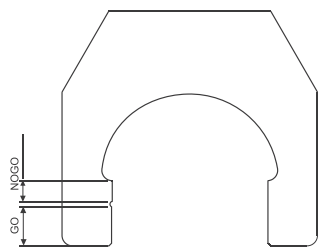

Type	Range	'GO' Length	'NO GO' Length	Thickness
Single Ended Snap Gauge Steel Blank (Carbide tipped/Steel)	45-60	16	9	8.5

\* All figures in mm

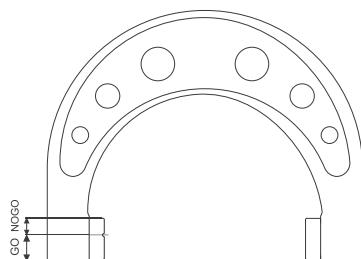

Type	Range	'GO' Length	'NO GO' Length	Thickness
Single Ended Snap Gauge C.I. Blank (Carbide tipped/Steel)	60-150	15	10	10
	150-400	18	12	10

\* All figures in mm

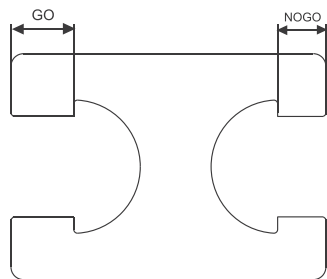

Type	Range	'GO' Length	'NO GO' Length	Thickness
Single Ended Snap Gauge Steel Blank (Carbide tipped /Steel)	1-10	8	5	6
	10-16	10	6	8.5
	16-25	12	8	8.5
	25-32	14	10	8.5
	32-40	16	12	8.5
	40-50	18	12	8.5
	50-65	20	13	8.5

\* All figures in mm