

Length Bars





Manufactured from same special alloy steel used for Gauge blocks so as to achieve the finest properties. Bars are offered in 22mm and 12mm diameter in steps of 25mm. Bars of 12mm dia. can be used as Micrometer Setting Standards.

 25mm to 1000mm - standard sets

 Custom sizes upto 1000mm

 Steel

 Metric (1mm / 2mm Base) & Imperial

 Reference, Calibration, Inspection & Workshop Grade

 IS 7014 / BS 5317 standards in metric
BS 1790 in imperial

Specifications

▶ Standard Dimension of Length Bars up to 1000mm

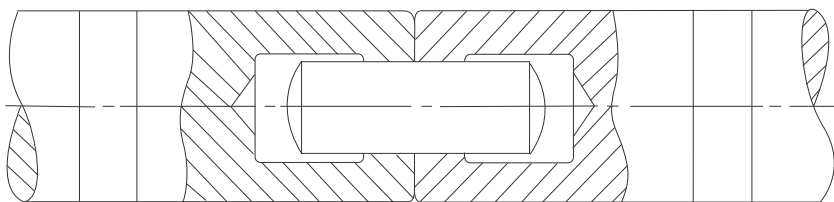
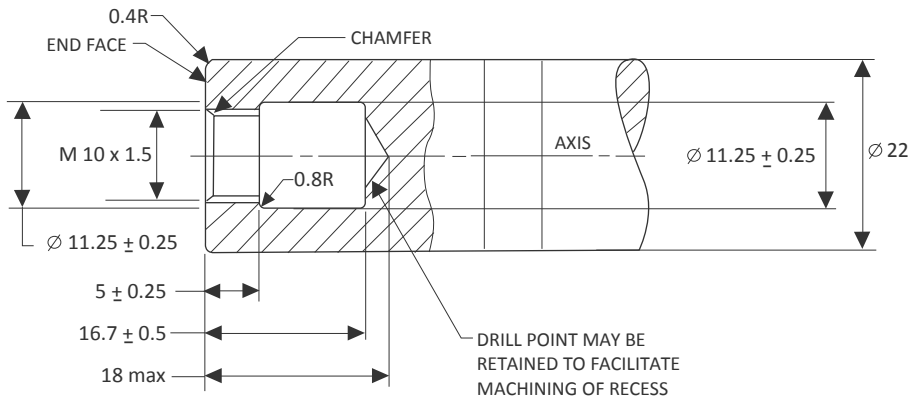

Combination of Length Bars

▶ Grades and their selection

Grades are selected as per the area of its use. KCP offers all grades available in standards.

Reference Grade: These are most accurate length bars, manufactured with plain ends (without threaded hole) and are used to establish standards.

Calibration Grade: They are used to calibrate inspection blocks and very high precision gauging.

Inspection Grade: These are manufactured with Internal threaded ends for combination purpose. These are used for Inspection/setting purpose.

Work shop Grade: These gauge blocks are used as shop standards for precision measurement.

Unique Features



Features of Length Bars

Special Alloy Steel, properly heat treated & hardened to 800 HV
Greater wear resistance
Dimensionally stable for long term use
Coefficient of thermal expansion:
 $(11.5 \pm 1) 10^{-6} \text{ k}^{-1}$



Certificate No. : C-0432

KCP Length Bars are supplied with Calibration Certificate issued from its accredited calibration lab.

All our Length standard products and accessories are delivered in quality wooden casing, appended with; Calibration Certificate traceable to National Standards and Instruction Manual on the use and care.